

TOTAL SITE AREA = 836.3 m²	
GROUND FLOOR PLAN	
OFFICE 1 =	78.5m ²
OFFICE 2 =	70m ²
OFFICE 3 =	78m ²
OFFICE 4 =	85m ²
COMMON AREA	65m ²
TOTAL AREA	376.5m ²
FIRST FLOOR PLAN	
OFFICE 5 =	80m ²
OFFICE 6 =	119m ²
UNIT 1 =	70m ²
UNIT 2 =	56m ²
UNIT 3 =	58m ²
UNIT 4 =	58m ²
UNIT 5 =	88m ²
COMMON AREA	30m ²
TOTAL AREA	553m ²
TOTAL OFFICE AREA	510.5m²
TOTAL RES AREA	330m²
TOTAL COMMON AREA	95m²

- ACT HOUSE ENERGY RATING SCHEME
14 points 5.5 stars
30 OCT 2008
ALEX KWINGO 01-40802
- ACT HOUSE ENERGY RATING SCHEME
28 points 6 stars
30 OCT 2008
ALEX KWINGO 01-40802
- ACT HOUSE ENERGY RATING SCHEME
31 points 6 stars
30 OCT 2008
ALEX KWINGO 01-40802
- ACT HOUSE ENERGY RATING SCHEME
25 points 5 stars
30 OCT 2008
ALEX KWINGO 01-40802
- ACT HOUSE ENERGY RATING SCHEME
6 points 5 stars
30 OCT 2008
ALEX KWINGO 01-40802

NEIGHBOURING RESIDENTIAL DEVELOPMENT
GROUND FFL 569.97

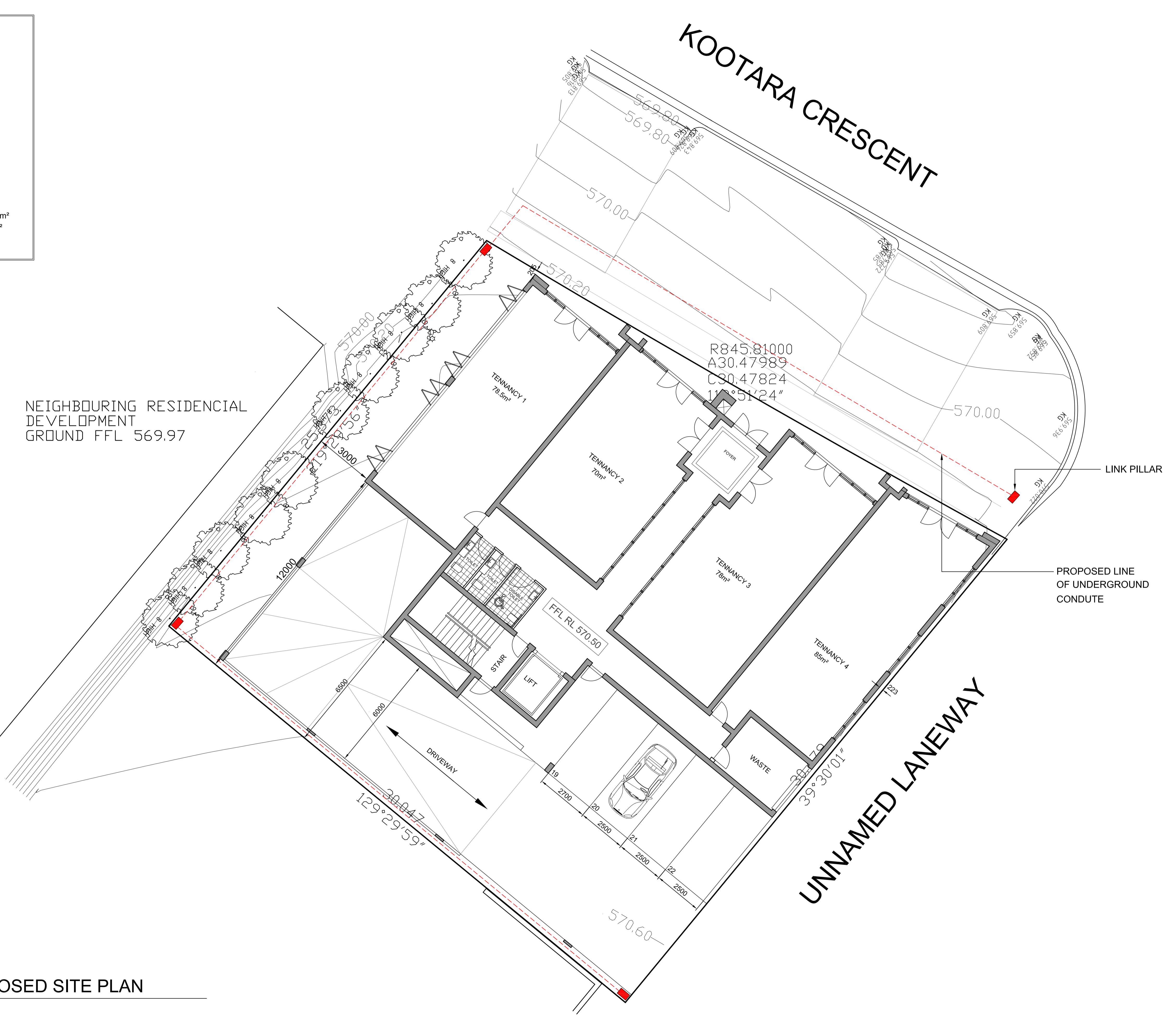

PROPOSED SITE PLAN

© COPYRIGHT ARCHITECTS RING & ASSOC. PTY LTD. 2005
NOTE:

CONTRACTOR MUST VERIFY ALL DIMENSIONS ON SITE BEFORE COMMENCING ANY WORK OR DRAWING SHOP DRAWINGS. DO NOT SCALE DRAWING.



Date	No	Amendments	Code

GENERAL NOTES:
ALL WORK TO BE CONSTRUCTED IN ACCORDANCE WITH RELEVANT AUSTRALIAN STANDARDS, BUILDING CODE OF AUSTRALIA AND LOCAL AUTHORITIES REGULATIONS. EXECUTE ALL WORK IN THE BEST AND MOST TRADESMAN LIKE MANNER AND TO THE SATISFACTION OF THE SUPERINTENDENT. ALL DIMENSIONS ARE IN MILLIMETERS UNLESS OTHERWISE NOTED.



ARCHITECTS
RING & ASSOCIATES
ARCHITECTS INTERIOR DESIGN
56 LEFFROY STREET, GRIFFITH, CANBERRA, 2603
PH: (02) 62239 7177 FAX: (02) 62239 7100 ACN00952967
ARCHITECTS RING AND ASSOCIATES PTY/LTD

PROJECT
MIXED USE

CLIENT
POWDERLY

BLOCK	SECTION	DIVISION
13	28	NARRABUNDAH

DRAWING TITLE
SITE PLAN

DATE	SCALE (A1)	DRAWN	CHECKED
DEC.07	1:100	RI CAD	TERRY RING
JOB NO.	DWG NO.	CODE	
0772	A04		

FILE NAME: I:\C:\DWG\REV\1\0772\13-Narrabundah\POWDERLY\0772\28-Narrabundah\0772\001.dwg 31/10/08 11:25am