

STABILISED CONSTRUCTION ENTRANCE
NOT TO SCALE

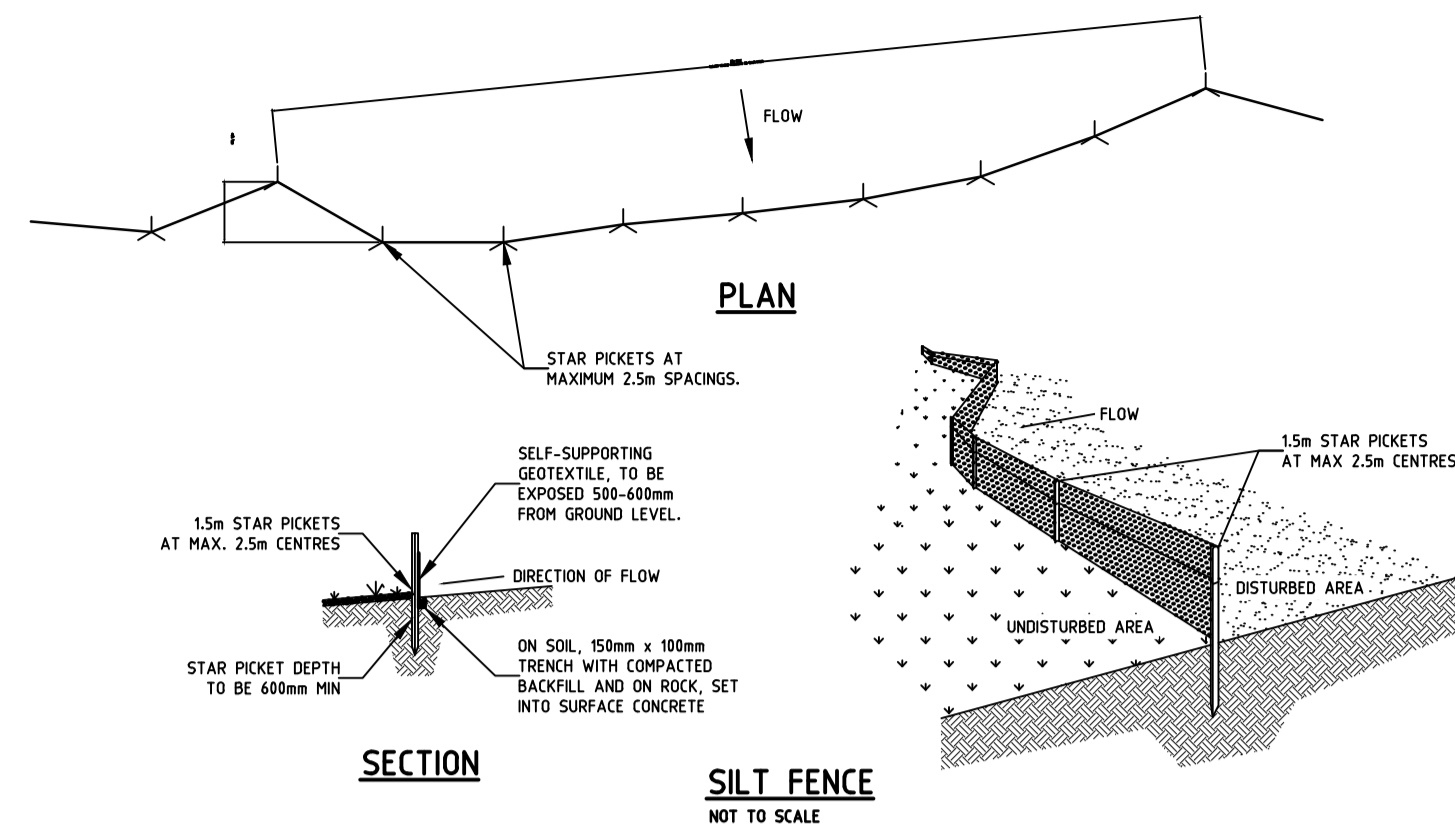

SILT FENCE
NOT TO SCALE

CONTACT DETAILS

PROJECT MANAGER:
SITE MANAGER:

HOURS OF OPERATION

SITE WORKS TO BE CONDUCTED ONLY BETWEEN THE FOLLOWING HOURS:

- WEEKDAYS 7.00AM TO 6.00PM;
- SATURDAYS 7.00AM TO 6.00PM
- SUNDAYS BUILDING WORK MUST NOT EXCEED NOISE STANDARD

GENERAL NOTES

1. WASTE ENCLOSURE(S) ARE TO BE USED FOR ALL RUBBISH ON SITE AND RUBBISH REMOVED FROM ENCLOSURE(S) WHEN REQUIRED OR FULL.
2. ALL WORK MUST COMPLY WITH ENVIRONMENT PROTECTION GUIDELINES FOR CONSTRUCTION AND LAND DEVELOPMENT IN THE ACT.

CUT AND FILL VOLUMES

CUT TBAM³

FILL TBAM³

EXCESS SOIL TO BE DISPOSED OF AT AN ENVIRONMENT PROTECTION AUTHORITY APPROVED LOCATION.

NOISE

ENSURE ALL BUILDING WORK THAT GENERATES NOISE IS CONDUCTED WITHIN THE TIME PERIODS DETAILED IN SCHEDULE 2 OF THE ENVIRONMENT PROTECTION REGULATIONS 2005.

BUILDING WORK DETAILS	MONDAY TO SATURDAY	SUNDAY AND PUBLIC HOLIDAYS
INDUSTRIAL, CITY AND TOWN CENTRE AREAS	6AM TO 8PM	6AM TO 8PM
ANY OTHER AREA WHEN WORK COMPLETED WITHIN 2 WEEKS	7AM TO 6PM	8AM TO 8PM
ANY OTHER AREA WHEN WORK NOT COMPLETED WITHIN 2 WEEKS	7AM TO 6PM	BUILDING WORK MUST NOT EXCEED NOISE STANDARD

IN ADDITION:

1. SCHEDULE NOISY ACTIVITIES FOR THE LEAST SENSITIVE TIMES OF THE DAY SUCH AS MID-MORNING AND MID-AFTERNOON.
2. SELECT MACHINERY THAT PRODUCE LESS NOISE; AND
3. ENSURE MACHINERY IS WELL MAINTAINED.

NOTE

ALL WORK IS TO COMPLY WITH ENVIRONMENT PROTECTION GUIDELINES FOR CONSTRUCTION AND LAND DEVELOPMENT 2011

SEDIMENT CONTROL NOTES

1. SEDIMENT AND EROSION CONTROL DEVICES ARE TO BE INSTALLED AND FULLY OPERATIONAL PRIOR TO STRIPPING OF SITE TOP SOIL.
2. STOCK PILE/S TO BE LOCATED AWAY FROM DRAINAGE LINES AND SURFACE FLOW PATHS. CONTOURED STRIATIONS OR FURROWS TO BE PROVIDED TO STOCK PILES TO MINIMISE EROSION.
3. STABILISED CONSTRUCTION ENTRANCE TO BE CONSTRUCTED PRIOR TO ACCESS TO SITE BY CONSTRUCTION VEHICLES. AGGREGATE TO BE TURNED WHEN SEDIMENT BUILDS UP AND RENEWED WHEN REQUIRED.
4. WHERE UNDERGROUND STORMWATER DRAINAGE IS INSTALLED TO INTERNAL ROADWORKS, PROVIDE INLET FILTER IN ACCORDANCE WITH GIVEN DETAIL.
5. AVERAGE EXISTING SITE SLOPE 1.0%
6. TOTAL SITE AREA 3,260m².
7. ENVIRONMENT PROTECTION AGREEMENT TO BE TAKEN OUT BY BUILDING CONTRACTOR WITH ENVIRONMENT PROTECTION AUTHORITY. (TELEPHONE 132281)
8. ALL NEW CONSTRUCTION WORK MUST BE CONTAINED WITHIN THE SITE EXCEPT FOR APPROVED SERVICE CONNECTIONS AND ROADWORKS.
9. LIMIT ACCESS TO SITE DURING AND IMMEDIATELY AFTER WET WEATHER.
10. REGULARLY REMOVE ANY SOIL FROM ROADS ADJACENT TO THE SITE.
11. NO STORAGE OF CONSTRUCTION MATERIALS, PARKING OF VEHICLES NOR EQUIPMENT PERMITTED OUTSIDE OF BLOCK WITHOUT TAMS APPROVAL.
12. NO SITE SHEDS, STORAGE SHEDS, SITE AMENITIES TO BE ERRECTED OUTSIDE OF BLOCK WITHOUT TAMS APPROVAL.
13. PROVIDE KERBSIDE FILTER ROLL TO EXISTING SUMPS WHERE INDICATED, REFER TO GIVEN DETAIL.
14. KERBSIDE FILTER ROLLS TO BE REMOVED, CLEANED AND REINSTATED ON A WEEKLY BASIS AT A MINIMUM. TRAPPED SEDIMENT ABOUT SUMPS ALSO TO BE REMOVED. CLEANING IS ALSO TO TAKE PLACE IMMEDIATELY AFTER PERIODS OF RAINFALL DURING CONSTRUCTION.
15. ALL SERVICE TRENCHES TO BE BACK FILLED WITHIN 24HOURS OF INSPECTION.
16. EXCESS SOIL IS TO BE DISPOSE AT AN ENVIRONMENT PROTECTION AUTHORITY APPROVED LOCATION.
17. THE SITE FOREMAN IS TO CONTACT THE ENVIRONMENT PROTECTION AUTHORITY (132281) TO ARRANGE A SITE INSPECTION AND ENDORSEMENT OF SEDIMENT AND EROSION CONTROL MEASURES PRIOR TO WORKS COMMENCING.
18. THE SITE FOREMAN IS TO CONTACT THE ENVIRONMENT PROTECTION AUTHORITY (132281) TO DISCUSS ANY PROPOSED MAJOR CHANGES TO SEDIMENT AND EROSION CONTROLS ON SITE PRIOR TO IMPLEMENTING THE CHANGES.
19. THE SITE FOREMAN IS TO ENSURE CONTRACTORS ACCESS AND EXIT THE SITE USING ONLY ENVIRONMENT PROTECTION AUTHORITY APPROVED STABILISED ACCESS/EXIT POINTS AS DETAILED ON ENDORSED SEDIMENT AND EROSION CONTROL PLANS.

MAINTENANCE SCHEDULE

WEEKLY:

1. TURN OVER STABILISED CONSTRUCTION ENTRY MATERIAL AND RENEW WHEN REQUIRED.
2. CHECK AND REINSTATE SILT CONTROL FENCES.

DAILY:

- SWEEP AND REMOVE DIRT AND ANY OTHER BUILDING MATERIAL FROM GUTTERS, FOOTPATHS OR ROADWAYS ADJACENT TO THE SITE BY CLOSE OF BUSINESS AND OR PRIOR TO RAIN AND WHEN REQUIRED. ALL NECESSARY STEPS SHOULD BE TAKEN THAT ARE PRACTICAL AND REASONABLE TO MINIMISE DUST POLLUTION.

DURING/AFTER WET WEATHER:

3. LIMIT CONSTRUCTION VEHICLE ACCESS TO SITE DURING AND IMMEDIATELY FOLLOWING WET WEATHER.

DUST MANAGEMENT

WHERE BUILDING WORK GENERATES DUST, ALL REASONABLE AND PRACTICABLE MEASURES SHOULD BE TAKEN TO MINIMISE THAT DUST.

THIS CAN OFTEN BE ACHIEVED BY

1. RETAIN EXISTING VEGETATION WHERE POSSIBLE
2. STRIPPING AREAS PROGRESSIVELY AND ONLY WHERE IT IS NECESSARY FOR WORKS TO OCCUR;
3. EMPLOYING STABILISING METHODS SUCH AS MATTING, GRASSING OR MULCH;
4. DAMPENING THE GROUND WITH A LIGHT WATER SPRAY (CONTACT THE ENVIRONMENT PROTECTION AUTHORITY FOR REQUIREMENTS DURING EXTREME DROUGHT CONDITIONS);
5. ROUGHENING SURFACE OF EXPOSED SOIL;
6. COVERING STOCKPILES AND LOCATING THEM WHERE THEY ARE PROTECTED FROM THE WIND;
7. RESTRICTING VEHICLE MOVEMENTS;
8. COVERING THE LOAD WHEN TRANSPORTING MATERIAL;
9. CONSTRUCTING WIND BREAKS SUCH AS WIND FENCES IN ACCORDANCE WITH THE BLUE BOOK;
10. A WATER CART OR SUFFICIENT WATER SPRAYS SHALL BE MADE AVAILABLE AT ALL TIMES. IN ADVERSE CONDITIONS WHEN DUST CANNOT BE ADEQUATELY CONTROLLED WHEN WORKS ARE BEING UNDERTAKEN, WORKS WILL CEASE IN THESE AREAS UNTIL CONDITIONS IMPROVE;
11. WATER SHALL BE APPLIED TO SUPPRESS DUST FROM OPEN EARTHWORKS AS WELL AS UNPROTECTED STOCKPILES;
12. AREAS OF COMPLETED EARTHWORKS SHALL BE PROGRESSIVELY REHABILITATED WITH DRYLAND GRASS AND FENCED OFF AS SOON AS PRACTICABLE TO PREVENT FURTHER EROSION;
13. THE CONTRACTOR SHALL CONTACT ACTEWAGL TO OBTAIN RECYCLED WATER FROM THE LOWER MOLONGOLO;
14. THE CONTRACTOR IS TO CONTACT THE WATER RESOURCES UNIT TO OBTAIN AN EXEMPTION TO USE NON-POTABLE WATER FROM ON OR OFF THE SITE IF REQUIRED;

DISPOSAL OF SPOIL

PRIOR TO ANY WORKS COMMENCING INVOLVING EXPORT OF SPOIL GREATER THAN 100m³, THE FOLLOWING INFORMATION MUST BE PROVIDED TO THE ENVIRONMENT PROTECTION AUTHORITY VIA EMAIL (environment.protection@act.gov.au).

1. WHERE THE SPOIL WILL ORIGINATE FROM: WHO IS DISPOSING OF THE SPOIL: WHERE THE SPOIL WILL BE TAKEN: THE AMOUNT OF SPOIL TO BE TAKEN AWAY
2. MOVEMENT DATES AND CONTACT DETAILS: DESCRIPTION OF THE TYPE OF SPOIL TAKEN AWAY: DETAILS OF HOW RECORDS WILL BE KEPT; AND
3. TIME FRAME TO COMPLETE THE WORKS TO THE SATISFACTION OF THE ENVIRONMENT PROTECTION AUTHORITY.

SPOIL MAY BE TAKEN TO AN APPROVED LANDFILL SITE WITHOUT APPROVAL. IF THE SPOIL IS TO BE TAKEN TO AN AREA OTHER THAN APPROVED LANDFILL SITE, ENSURE THE ACCEPTOR OF THE SPOIL IS AWARE OF THE REQUIREMENTS SETOUT IN SECTION 8.2 OF THE ENVIRONMENT PROTECTION GUIDELINES FOR CONSTRUCTION AND LAND DEVELOPMENT IN THE ACT.

FIRE

BURNING OF WASTE MATERIALS ON THE SITE, SUCH AS PLASTICS, CHEMICALS OR WOOD THAT MAY BE PAINTED, CHEMICALLY TREATED OR CONTAMINATED WITH CHEMICALS IS ILLEGAL. A FIRE MAY BE PERMITTED FOR HEATING PURPOSES PROVIDED IT IS IN A BRAZIER OR CONSTRUCTED FIREPLACE. ONLY SEASONED, UNTREATED TIMBER CAN BE BURNED FOR HEATING PURPOSES.

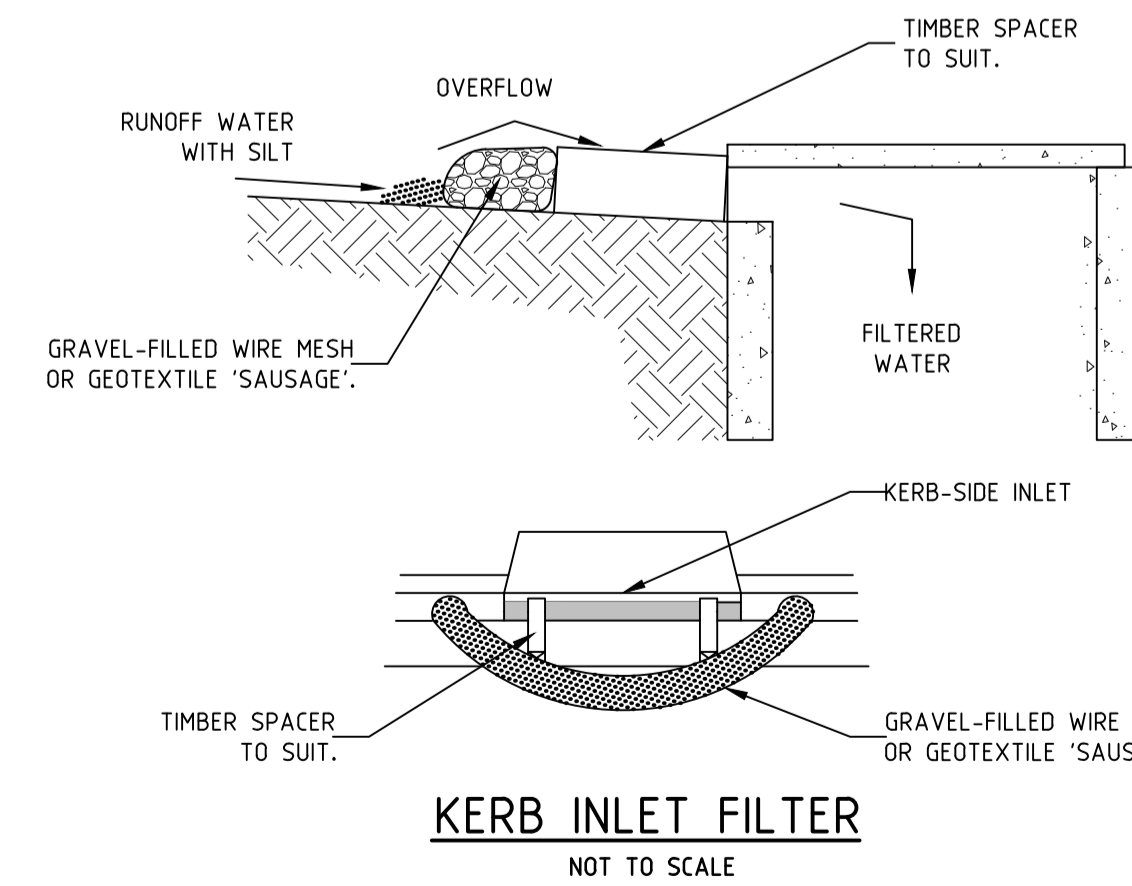

KERB INLET FILTER
NOT TO SCALE

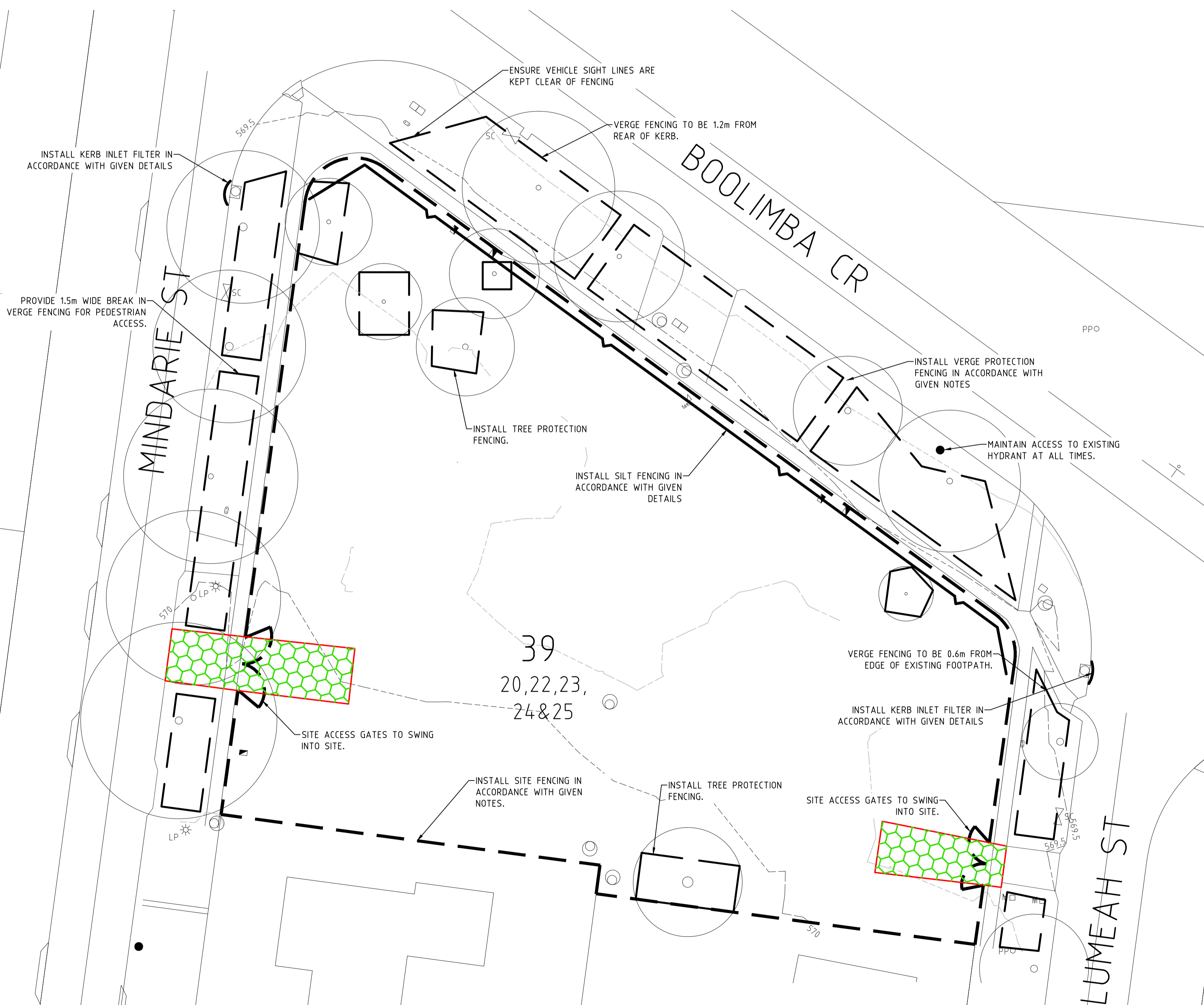

ISSUE	DESCRIPTION	DATE	DRAWN	AMEND	DESCRIPTION	DATE	DRAWN
A	FOR DEVELOPMENT APPROVAL	30.06.14	CMO				
A	FOR REVIEW	06.06.14	CMO				

DO NOT SCALE OFF DRAWINGS. VERIFY ALL DIMENSIONS ON SITE BEFORE COMMENCING WORK.
COPYRIGHT: The concepts and information contained in this document are copyright of Sellick Consultants. Use or copying of this document in whole or in part without written permission constitutes an infringement of copyright.

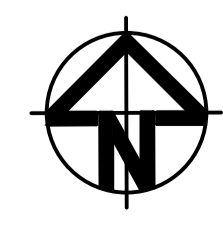

PROJECT TITLE
PROPOSED BLOCK AMALGAMATION

CLIENT
ACT HOUSING

DESIGNED BY
CMO

CHECKED BY
BC

AUTHORISED BY

DATE
30/06/2014

DRAWING TITLE
POLLUTION CONTROL PLAN

PROJECT LOCATION
BLOCKS 20,22,23,24&25 SECTION 39, NARRABUNDAH

SCALE 0m 2.5 5 7.5 10 12.5 1:250 @A1 1:500 @A3	JOB NO. 140028	DRAWING NO. C102
--	--------------------------	----------------------------